

SIGNATURE

NORTH EAST

OFFICIALLY RATED THE NO.1 ESTATE AGENT IN THE NORTH EAST





 Magpie Court, Ashington NE63 8LN

Magpie Court, Ashington NE63 8LN

Offers Over £215,000

Signature North East are proud to welcome this beautiful two-bedroom bungalow to the sales market, this property boasts modern décor and spacious living throughout. Ideally situated in the quaint town of Ashington on Magpie Court with an array of practical amenities only a short commute away such as bars, restaurants, and shops.

Upon entry into the property finds a welcoming entrance hallway with access to all of the principal rooms, first are both double-sized bedrooms which offer ample space for furnishings. In between the bedrooms is the family bathroom, fully fitted with a large bath, overhead shower, heated towel rail and sink unit. The sleek brown tiling help to give the room a modern, stylish feel to it. The large living area offers a great deal of space for furnishings and the French sliding doors leading into the conservatory allow for an abundance of light to shine through creating a bright and airy atmosphere. The additional space is currently being used as a dining room which is perfect for hosting family and friends. Leading into the kitchen which is fully equipped with integrated appliances such as a fridge, oven, heated drawer, and overhead extractor fan. The granite worktops and dark wooden effect of the kitchen cupboards create an elegant touch to the room whilst also having plenty of space for storage.

Externally, the rear of the property has a sizable garden area with a shed for extra storage. To the front of the property is a garage which is easily accessed from the kitchen and a driveway big enough for one car to park.



PLEASE NOTE THAT THE VENDOR HAS CERTIFIED THE PROPERTY INFORMATION AND IMAGES.

PROPERTY FLOORPLAN

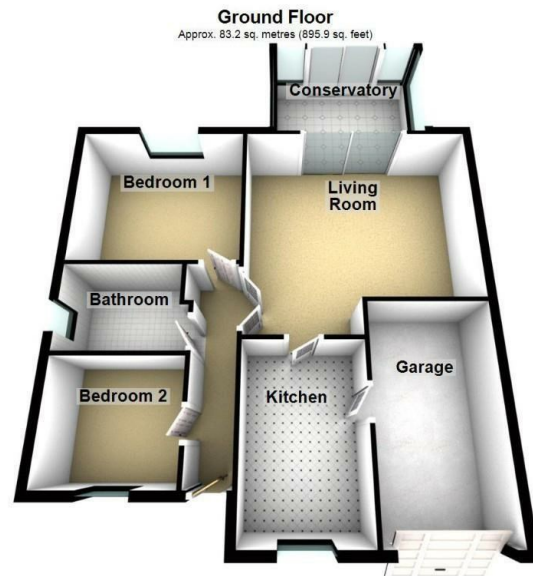

Ground Floor
Approx. 83.2 sq. metres (895.9 sq. feet)

Total area: approx. 83.2 sq. metres (895.9 sq. feet)

Please be advised the floorplans are not drawn to scale and are to be used to give an idea of the layout of the property.
Plan produced using PlanUp.

Measurements:

Energy Efficiency Rating

	Current	Potential
Very energy efficient - lower running costs		
(92 plus) A		87
(81-91) B		
(69-80) C	71	
(55-68) D		
(39-54) E		
(21-38) F		
(1-20) G		
Not energy efficient - higher running costs		

England & Wales

EU Directive
2002/91/EC







More 5 Star Customer Reviews than any other Agent based in the North East on allAgents.co.uk



SALES

LETTINGS

FINANCE

LAW

WE COVER THE WHOLE OF THE NORTH EAST

Whitley Bay
0191 251 3344

Cramlington
01670 897 213

Tynemouth
0191 296 6689

Morpeth
01670 513 966

Ponteland
01661 820 082

Wallsend
0191 432 4151

Alnwick
01665 511 800

Heaton
0191 432 4275

Forest Hall
0191 266 9966

Other locations
0191 640 3523

Newcastle
0191 640 2284

Durham
0191 303 8252

Gosforth
0191 640 3523

Sunderland
0191 543 6390

Whickham
0191 432 5102

Gateshead
0191 432 4294

Jesmond
0191 281 1037

Killingworth
0191 640 3602

Ryton
0191 413 9845

Head Office &
Lettings
0191 253 4815

*Highest recommended 5-star reviews than any other Estate Agent based in the North East on allAgents.co.uk - The UK's Largest Customer Review Website for the Property Industry & Awarded Best Estate Agency 2018 & 2019 - North East England by SME News